

File Name: P:\Projects\2023\237806 Blossman Gas Pompano\CA00 FieldDrawings\237806-PLANTING_PLANS.dwg - (Plotted by: Marcos Mendez on Wednesday, May 14, 2025 12:08:32 PM)

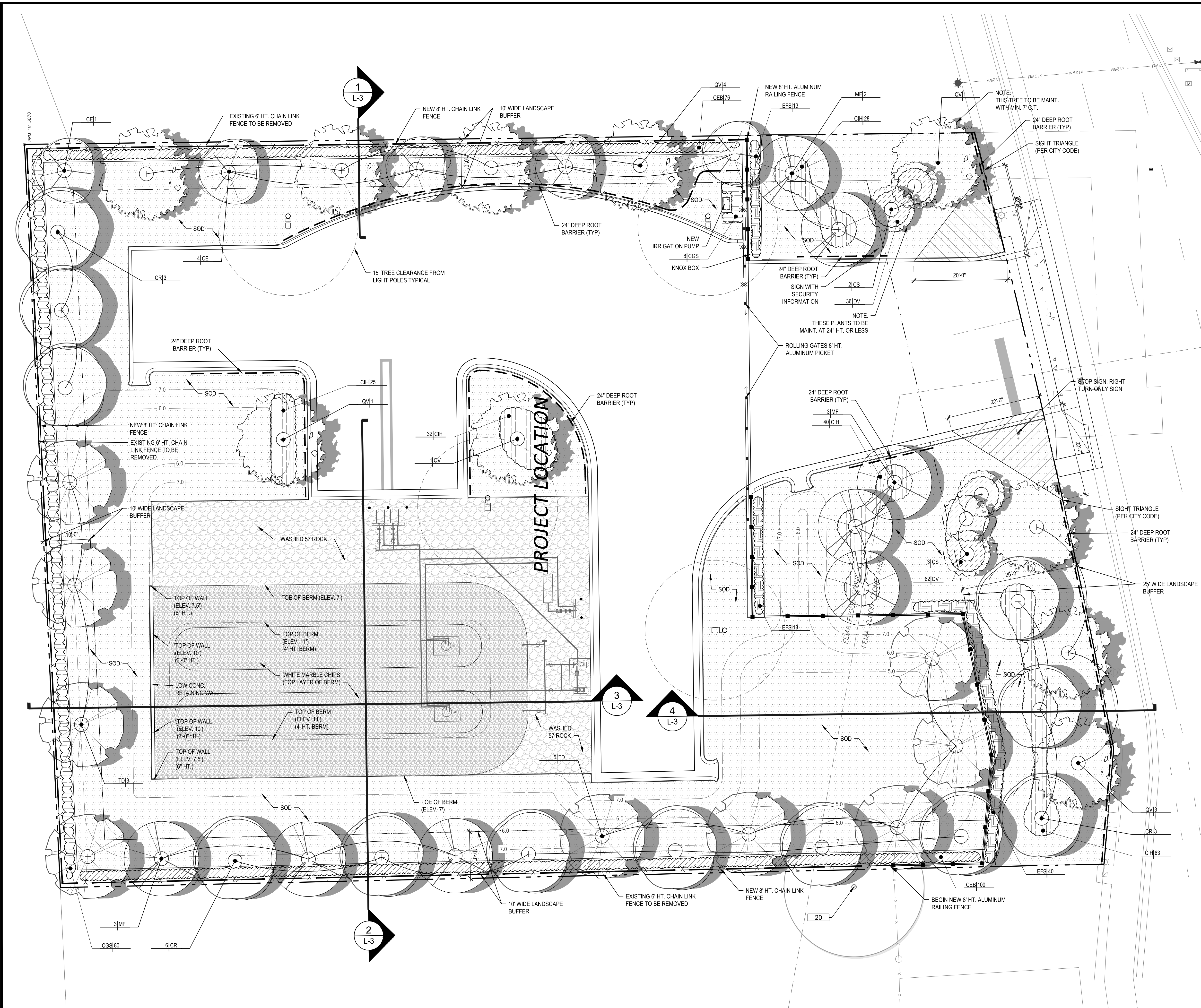

PLANT SCHEDULE					
SYMBOL	CODE	QTY	BOTANICAL / COMMON NAME	SIZE	ADD. SPECS
CANOPY TREES					
	CR	12	Clusia rosea Autograph Tree	F.G. 14' HT x 6', 2.5' DBH, 4.5' CT	
	CE	5	Conocarpus erectus f. sericeus Silver Buttonwood	F.G. 14' HT x 6', 2.5' DBH, 4.5' CT	
	MF	8	Myrcianthes fragrans Simpson's Stopper	F.G. 14' HT x 6', 2.5' DBH, 4.5' CT	
	QV	10	Quercus virginiana Southern Live Oak	F.G. 14' HT x 6', 2.5' DBH, 4.5' CT	
	TD	9	Taxodium distichum Bald Cypress	F.G. 14' HT x 6', 2.5' DBH, 4.5' CT	
UNDERSTORY TREES					
	CS	5	Cordia sebestena Orange Geiger Tree	F.G. 10' HT. X 4' SPR., 2' CAL.	
SHRUB AREAS					
	CGS	88	Clusia guttifera Small Leaf Clusia	24' x 24'	Full to ground, 24" o.c.
	CEB	176	Conocarpus erectus Green Buttonwood	24' x 24'	Full to ground, 24" o.c.
	EPS	66	Eugenia foetida Spanish Stopper	24' x 24'	Full to ground, 24" o.c.
GROUND COVERS					
	CH	188	Chrysobalanus icaco 'Horizontalis' Horizontal Cocoa Plum	18' x 8'	Full to ground, 24" o.c.
	DV	98	Dianella tasmanica 'Variegata' Variegated Flax Lily	15' x 5'	Full to ground, 18" o.c.
	SOD	14,732 sf	Stemodia secundatum 'Floratum' Floratum St. Augustine Grass	Sod	

Planting Requirements					
Zoning:	-1 General Industrial				
Lot Area:	34,443 SQ FT				
Landscape Area:	18,357 SQ FT				
Code Section	Description	Required		Provided	
		Trees	Shrubs	Trees	Shrubs
155.5203.C	1 tree and 5 shrubs per 3000 Sq Ft of lot area.	12	60	12	61
155.5203.D.4	1 tree required per parking island.	2	—	2	57
155.5203.F.3	Required Buffers for Industrial Zoning use a Type C Buffer with option 1 or 2				
	North Property Type A: 203.63' / 30'	7	102	7	117
	East Property Type C: 160' - 34' / 30' Canopy	5	63	5	189
	East Property Type C: 160' - 34' / 30' Understory	5		5	
	South Property Type A: 223.72' / 30'	8	112	8	112
	West Property Type A: 159.53' / 30'	6	80	6	80
155.5203.G.2b	Street Trees 1 per 40 linear feet	4	—	4	—
Total Trees & Shrubs Required / Provided:		49	417	49	616
Notes: Trees Shall be a minimum of 14' in Height Shrubs shall be a minimum of 2' in height by 2' spread, 2' O.C.					

Note: Per City Ordinance(s) §50.02(A)(4) and §100.35(E), Landscaping materials other than sod are not allowed within (5') five feet of any portion of City owned utilities within the public street right-of-way including meters, hydrants, service lines etc. Also, please note that no trees, shrubbery or obstruction shall be placed within a 3' radius of a City-owned sewer lateral cleanout or water #/or reuse meter. Show the location of all existing City owned and maintained potable water mains and services, sanitary sewer mains or laterals and storm drainage lines on the proposed landscape plans. Contact the Engineering Div. for Utility Information. Engineering Standard street tree detail 316-1. Landscaping materials to have the Utilities overlaid onto the plan sheets.

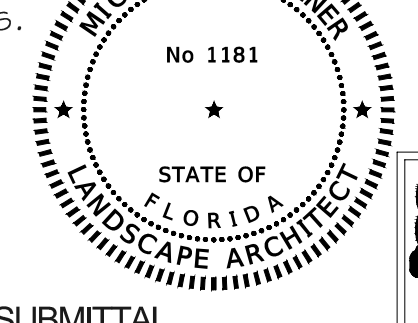

MINOR SITE PLAN SUBMITTAL
ELEVATIONS SHOWN ARE NAVD 88

Calvin, Giordano & Associates, Inc.
A SAFEQUIT COMPANY
580 Village Blvd., Suite 325, West Palm Beach, FL 33409
Phone: 561.684.6161 • Fax: 561.684.6160

BLOSSMAN GAS COMPANY
261 S. ANDREWS AVENUE
POMPAÑO BEACH, FL 33069

PLANTING PLAN & SCHEDULE

MICHAEL CONNER, STATE OF FLORIDA REGISTERED LANDSCAPE ARCHITECT, LICENSE NO. 1181. THIS ITEM HAS BEEN DIGITALLY SIGNED AND SEALED BY MICHAEL CONNER, R.L.A. ON THE DATE INDICATED HERE. PRINTED COPIES OF THIS DOCUMENT ARE NOT CONSIDERED SIGNED AND SEALED AND THE SIGNATURE MUST BE VERIFIED ON ANY ELECTRONIC COPIES. DATE: 05/09/2025	SCALE AS SHOWN	SHEET L-2
	PROJECT No	
	23-7806	